

Electric water heaters



Large range from
10 L to 300 L
for domestic use

 **PACIFIC**

Since 1938, the French family-owned Pacific brand has been developing and manufacturing domestic and commercial water heaters for its customers worldwide.

Pacific brand belongs to GROUPE ATLANTIC, recognized as one of the world leading manufacturers of multi-energy thermal comfort solutions (electric heating, water heaters, gas and fuel boilers, heat pumps etc).

Our Group manufactures all together over 2.6 million water heaters a year and that experience is shared with you in every water heater we provide.

Pacific brings you today a state-of-the-art range of water heaters. The techniques that we use today are the result of more than 70 years of experience and know-how.

Our commitment to the quality and reliability of our products, as well as the customer satisfaction forged our strong reputation as experts in water heating.



The ISO 9001 Certificate has been attributed to several GROUPE ATLANTIC manufacturing plants for their entire production.

Contents

- 3 ● Key advantages
- 4 ● Point-of-use water heaters
- 5 ● Vertical water heaters
- 6 ● Horizontal water heaters
- 7 ● Floor standing water heaters

www.groupe-atlantic.com



Direct immersion heating element: an approved solution

The sheathed heating element is made from copper or stainless steel. It offers high-level performance thanks to its balanced charge, providing extra longevity.

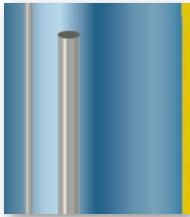

Magnesium anode

The sacrificial magnesium anode is located in the centre of the enamelled tank and provides excellent protection against corrosion.



Exclusive O'Pro technology

The ohmic resistor is a passive electronic anti-corrosive device. It balances out the electrical potential of the tank and immersion heating element. The magnesium anode life is considerably increased and protection against corrosion is reinforced.

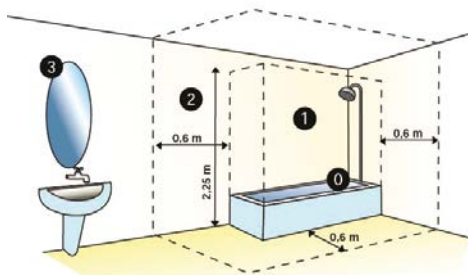

IP INDEX: Protection against water spray

The water heater's protection level against water spray is defined by its IP index. This outlines safe areas for installing electric appliances near water drainage points. Pacific water heaters have a high IP index up to IP 25 and can be installed in areas 1, 2 and/or 3 of the bathroom depending on country regulation. Pacific products IP index guarantees safe operation.

High-density and environmentally-friendly insulation

The polyurethane foam insulation prevents thermal bridges and helps to maintain water at the set temperature for a longer period of time. Pacific foam contains 0% CFC and its high density reduces heat loss.

Reinforced protection against corrosion

Unprotected steel parts in contact with water are the weakest parts of all water heaters, most leakages originate from there. Pacific uses a unique lip gasket, granting no contact between the steel tank edge and water.

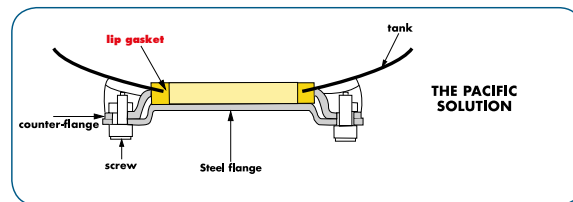
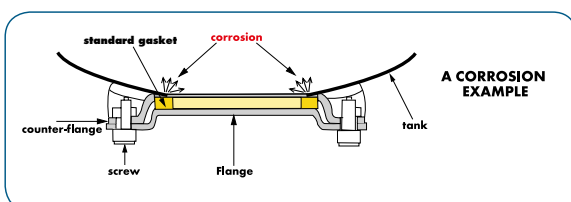

Point-of-use water heaters

with above and under sink configurations
10 L, 15 L and 30 L



- Compact and user-friendly water heater to fit in small spaces
- Sheathed heating element
- Long-lasting enamel (Zirconium & Diamond)
- O'Pro technology - exclusive passive electronic anti-corrosive system to permanently combat rust
- Magnesium anode for increased protection of the tank
- Optimised inlet diffuser
- Safety relief valve provided
- CFC-free high-density insulation foam
- Water heaters with white covers and adjustable temperature knob



• Technical data

Capacity (L)	Output (W)	Voltage (V~)	Heat-up time at 60°C (Δ=50°C)	Energy consumption (kWh/24h at 65°C)	Dimensions						Net weight (Kg)	ErP Energy class
					A	Ø	B	C	D	E		
10 above sink	1600	230 (220-240)	24	0.45	456	255	166	290	64	262	8	A
15 above sink	1600	230 (220-240)	35	0.51	496	287	169	327	70	294	9.5	B
30 above sink	2000	230 (220-240)	57	0.68	623	338	160	463	81	345	12.5	C
10 under sink	2000	230 (220-240)	19	0.69	456	255	238	218	64	262	8	B
15 under sink	2000	230 (220-240)	28	0.77	496	287	169	327	70	294	9.5	B

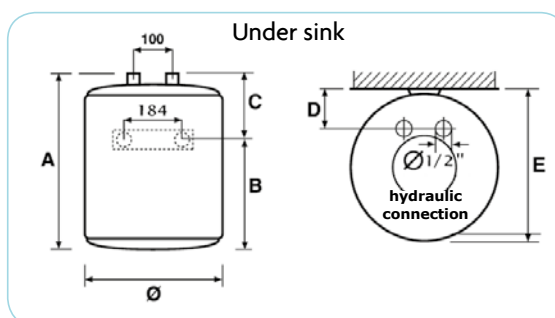
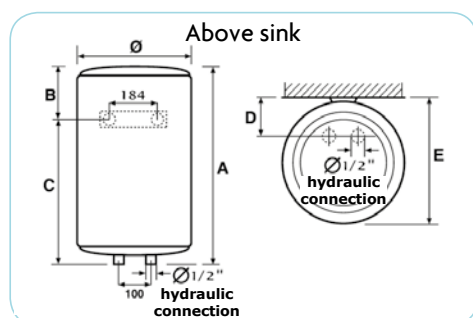

Vertical range

from 30 L to 200 L



- Long-lasting enamel (Zirconium & Diamond)
- Magnesium anode for increased protection of the tank
- Flange type heating element
- Exclusive O'Pro anti-corrosive system
- Easy installation
- External thermometer (30 L to 100 L)
- Heating indicator
- Safety relief valve provided
- CFC-free high-density insulation foam



Vertical water heaters

● Technical data

Capacity (L)	Output (W)	Voltage (V~)	Energy consumption (kW/24h at 65°C)	Heat-up time at 60°C (Δt=50°C)	Dimensions (mm)							Flange opening (mm)	Net weight (kg)	ErP Energy class
					A	B	C	D	E	F	G			
30	1200	230 (220-240)	0.36	1h30	447	433	235	451	165	300	240	72	11.5	C
50	1500	230 (220-240)	0.48	2h00	610	433	380	451	165	300	240	72	15	C
80	1500	230 (220-240)	1.17	3h14	857	433	590	451	165	300	240	72	20.5	C
100	1500	230 (220-240)	1.36	4h02	1005	433	740	451	165	300	240	72	24	C
150	1600	230 (220-240)	1.65	5h43	1220	505	800	520	169	440	-	-	39	C
200	2200	230 (220-240)	2.54	5h33	1550	505	800	525	171	440	-	-	48	C

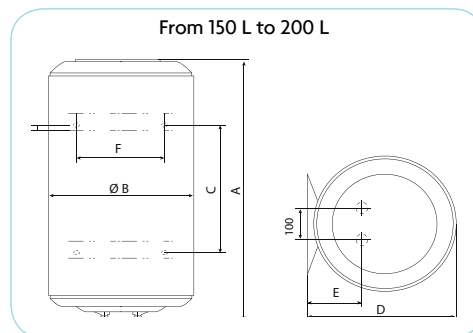
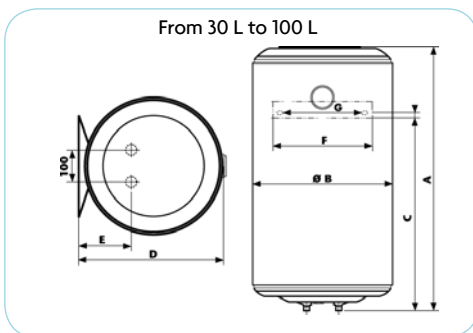

IP 25



MWP: 8 bar
TP: 16 bar



French Technology

Horizontal range

from 50 L to 200 L



- Long-lasting enamel (Zirconium & Diamond)
- Magnesium anode for increased protection of the tank
- Flange type heating element
- Exclusive O'Pro anti-corrosive system
- Easy installation
- Heating indicator
- Safety relief valve provided (50 L to 100 L)
- Mobile strapping for 150 L and 200 L



● Technical data

Capacity (L)	Output (W)	Voltage (V~)	Energy consumption (kW/24h at 65°C)	Heat-up time at 60°C (Δt=50°C)	Dimensions (mm)					Flange opening (mm)	Net weight (kg)	ErP Energy class
					A	Ø B	C	D	E			
50	1500	230 (220-240)	1.10	1h40	610	433	170	451	234	72	15	C
80	1500	230 (220-240)	1.34	2h45	848	433	360	451	234	72	21	C
100	1500	230 (220-240)	1.85	3h40	1005	433	510	451	234	72	24	D
150	2200	230 (220-240)	1.75	4h07	1140	530	800	550	285	-	39	C
200	2200	230 (220-240)	2.07	5h33	1460	530	800	550	285	-	48	D

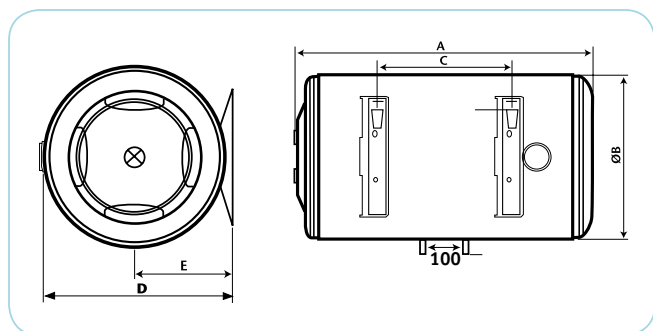

Floor standing range

200 L and 300 L



- Large tank capacity for more hot water
- Long-lasting enamel (Zirconium & Diamond)
- Magnesium anode for increased tank protection
- Flange type heating element: easy access to inner tank
- Exclusive O'Pro anti-corrosive system to permanently combat rust
- Easy to install
- Heating indicator
- CFC-free high-density insulation for more energy savings
- High-efficiency water inlet



Floor standing water heaters

● Technical data

Capacity (L)	Output (W)	Voltage (V~)	Energy consumption (kW/24h at 65°C)	Heat-up time at 60°C (Δt=50°C)	Dimensions (mm)						Net weight (kg)	ErP Energy class
					A	Ø	B	C	D	E		
200	2200	230 (220-240)	1.88	4h59	1260	575	270	160	30	590	51	C
300	3000	230 (220-240)	2.49	5h38	1760	575	270	160	30	590	73	C

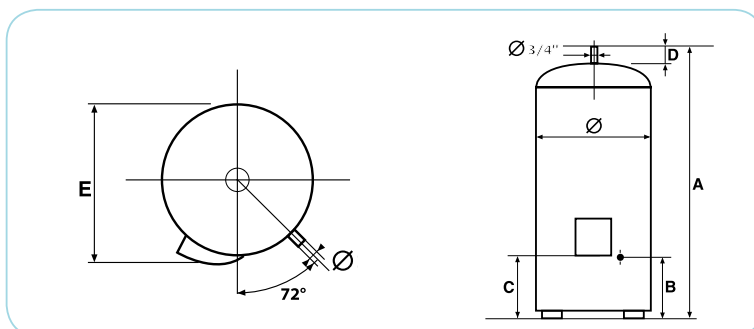

IP 24



MWP: 8 bar
TP: 16 bar



French Technology

UAE BRANCH
Mazen Aldabie

Email: uae@groupe-atlantic.com

Mob: +971 50 101 42 53

Tel: +971 444 29710 - Fax: +971 444 29715

Jumeirah Lakes Towers - Cluster V - JBC2

2007 P.O.BOX: 49713 Dubai, UAE

www.atlantic-comfort.ae

Local dealer



Atlantic International • 58, avenue du Général Leclerc • 92340 Bourg-la-Reine - France

Tel: (33) 1 46 83 60 00 - Fax: (33) 1 46 83 60 01