

U Strap Clamps are designed for clamping plain or insulated piping to the structural channel supports like trapeze hangers, floor stands and wall brackets

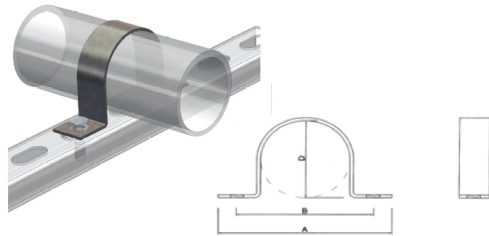

**Material :** Steel

**Finish :** Electrogalvanised post manufacture as standard.

**Options Available :** U-Strap Clamps with EPDM lining (suffix 'R')

Hot Dip Galvanized finish (suffix 'HDG')

Zinc Flake Finish (suffix 'ZF')

Stainless Steel construction (suffix 'SS')

**Compliance :** US Standards MSS-SP58 & 69 (Type 26),

Federal Specification : WW-H-171E & A-A-1192A (Type 26)

**Electro-Galvanized :** finish as per ASTM B633 SC3, BS1706 FE/ZN12.

**Selection :**

a) For insulated pipes, please specify the pipe OD plus the insulation thickness.

b) Where EPDM lining is required, please note that the effective ID of the lined U Strap clamp will reduce by 7-10mm.

Refer to the below selection chart for U-Strap clamp models for common pipe sizes with insulation thickness.

Steel Pipe Nom (OD)	G -FIX U Strap Clamp Model for Insulation/RSI Thickness						
	Bare Pipe	13mm	19mm	25mm	32mm	38mm	50mm
1/2"	GFUS 22	GFUS 48	GFUS 60	GFUS 72	GFUS 86	GFUS 98	GFUS 122
3/4"	GFUS 27	GFUS 53	GFUS 65	GFUS 77	GFUS 91	GFUS 103	GFUS 127
1"	GFUS 34	GFUS 60	GFUS 72	GFUS 84	GFUS 98	GFUS 110	GFUS 134
1 1/4"	GFUS 42	GFUS 68	GFUS 80	GFUS 92	GFUS 106	GFUS 118	GFUS 142
1 1/2"	GFUS 48	GFUS 74	GFUS 86	GFUS 98	GFUS 112	GFUS 124	GFUS 148
2"	GFUS 60	GFUS 86	GFUS 98	GFUS 110	GFUS 124	GFUS 136	GFUS 160
2 1/2"	GFUS 73	GFUS 99	GFUS 111	GFUS 123	GFUS 137	GFUS 149	GFUS 173
3"	GFUS 89	GFUS 115	GFUS 127	GFUS 139	GFUS 153	GFUS 165	GFUS 189
3 1/2"	GFUS 102	GFUS 128	GFUS 140	GFUS 152	GFUS 166	GFUS 178	GFUS 202
4"	GFUS 114	GFUS 140	GFUS 152	GFUS 164	GFUS 178	GFUS 190	GFUS 214
5"	GFUS 141	GFUS 167	GFUS 179	GFUS 191	GFUS 205	GFUS 217	GFUS 241
6"	GFUS 168		GFUS 206	GFUS 218	GFUS 232	GFUS 244	GFUS 268
8"	GFUS 219		GFUS 257	GFUS 269	GFUS 283	GFUS 295	GFUS 319
10"	GFUS 273		GFUS 311	GFUS 323	GFUS 337	GFUS 349	GFUS 373
12"	GFUS 323			GFUS 373	GFUS 387	GFUS 399	GFUS 423
14"	GFUS 356			GFUS 406	GFUS 420	GFUS 432	GFUS 456
16"	GFUS 406			GFUS 456	GFUS 470	GFUS 482	GFUS 506
18"	GFUS 457			GFUS 507	GFUS 521	GFUS 533	GFUS 557
20"	GFUS 508			GFUS 558	GFUS 572	GFUS 584	GFUS 608

Apart from the models listed in the table below, a full range in intermediate sizes are available to match the effective ODs of G-Fix RSI. This will further enhance the quality of the installation.

SELECTION TABLE FOR G-FIX U-STRAP CLAMPS							
Model	Steel Nominal		Pipe	Material Dimension(mm)		Bolt Size (mm)	Max Load (kg)
	In	mm	OD (mm)	Overall Dimension (A)	Distance Between two bolts (B)		
GFUS 1/2" (22mm)	1/2"	15	21.3	76	51	M8	500
GFUS 3/4" (27mm)	3/4"	20	26.7	82	57	M8	500
GFUS 1" (34mm)	1"	25	33.4	89	64	M8	500
GFUS 1 1/4" (42mm)	1 1/4"	32	42.1	96	71	M8	500
GFUS 1 1/2" (48mm)	1 1/2"	40	48.2	102	77	M8	500
GFUS 54mm			54	108	83	M8	500
GFUS 2" (60mm)	2"	50	60.3	114	89	M8	500
GFUS 67mm			67	121	96	M8	500
GFUS 2 1/2" (73mm)	2 1/2"	65	73	145	113	M8	600
GFUS 82mm			82	152	120	M8	600
GFUS 3" (89mm)	3"	80	88.9	160	128	M8	600
GFUS 3 1/2" (102mm)	3 1/2"	90	101.6	170	138	M8	600
GFUS 110mm				178	146	M8	600
GFUS 4" (114mm)	4"	100	114.3	185	153	M8	600
GFUS 126mm			126	196	164	M8	600
GFUS 5" (141mm)	5"	125	141.3	210	178	M10	600
GFUS 148mm			148	218	186	M10	600
GFUS 155mm			155	225	193	M10	600
GFUS 6" (168mm)	6"	150	168.3	237	205	M10	600
GFUS 179mm			179	249	217	M10	600
GFUS 190mm			190	260	228	M10	800
GFUS 205mm			205	275	243	M10	800
GFUS 8" (219mm)	8"	200	219.1	289	257	M10	800
GFUS 230mm			230	300	268	M10	800
GFUS 241mm			241	332	291	M12	1250
GFUS 263mm			263	354	313	M12	1250
GFUS 10" (273mm)	10"	250	273	364	323	M18	1250
GFUS 295mm			295	386	345	M18	1250
GFUS 12" (323mm)	12"	300	323.8	417	376	M18	1250
GFUS 14" (356mm)	14"	350	355.6	447	409	M18	1800
GFUS 374mm			374	465	427	M18	1800
GFUS 16" (406mm)	16"	400	406.4	497	459	M18	1800
GFUS 432mm			432	523	485	M18	1800
GFUS 18" (456mm)	18"	450	457.2	547	509	M18	1800
GFUS 482mm			482	573	535	M18	1800
GFUS 20" (508mm)	20"	500	508	599	561	M18	1800
GFUS 533mm			533	624	586	M18	1800
GFUS 559mm			559	650	612	M18	1800
GFUS 583mm			583	674	636	M18	1800
GFUS 24" (610mm)	24"	600	609.6	701	663	M18	1800
GFUS 658mm			653	766	721	M18	2300
GFUS 690mm			693	798	753	M18	2300
GFUS 760mm			763	868	823	M18	2300
GFUS 863mm			863	971	926	M18	2300

\*\*\* Product specifications are subject to change without prior notice.